

# ICS Group Standard Prefab Container Units



# ICS Prefab Units give you 4 direct benefits

## 1. Five standard versions

The ICS Prefab is delivered in 5 different cost effective standard versions with optional modifications possible.



## 2. Robust and durable

Robust and durable construction, insulated to highest standards that saves the A/C power up to 5 times.



## 3. Fast response teams

We have local production facility and local work-teams with extremely fast response time - we deliver on time - and now!



## 4. Reduce logistics

The ICS Prefab is flatpacked and stackable reducing transportation costs up to 4 times compared to standard prefabs.



# ICS Standard Prefabs 20'

## Basic Prefab

The basic modular unit. Suitable for offices, dormitories, dining halls etc.

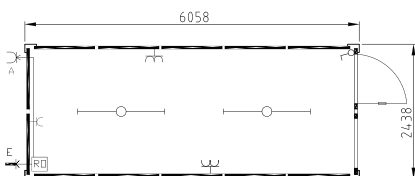

## 20' VIP prefab

Office or accommodation including private bath and toilet.

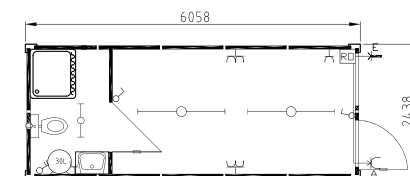

## 2 shower+3 toilets

Ablution unit with 4 washbasin, 2 showers, 3 toilets, 300 ltr. watertank

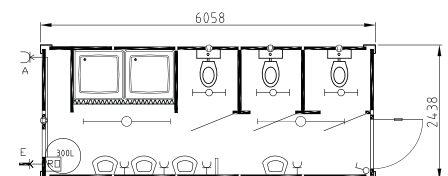
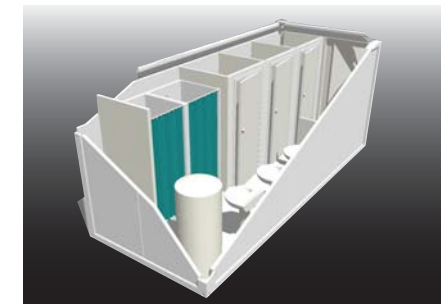

## 5 shower

Ablution unit with 5 showers, 6 washbasins and 300 ltr. watertank.

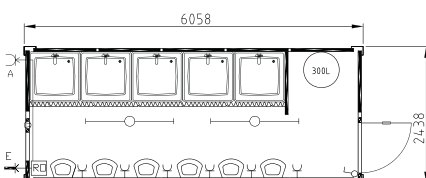
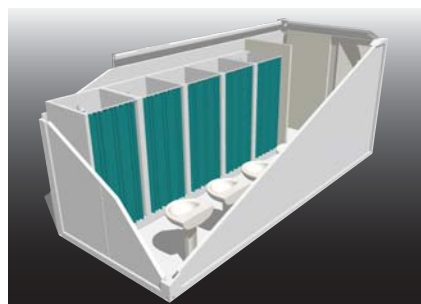

## 5 toilet

Ablution unit with 5 toilets, 3 washbasins, 3 urinals and 30 ltr. watertank.

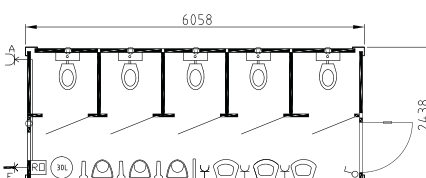
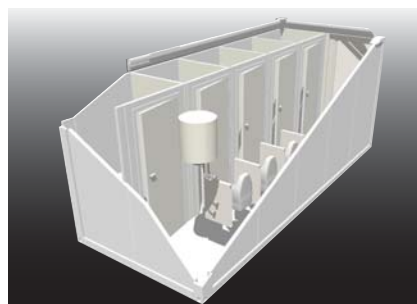

## Unit configuration

All units are insulated with 60 mm mineral wool

	Urinal	Washbasin	Shower	Toilet	Fan	Heater	Windows	Power outlets	Water heater	Light fittings	A/C unit
Basic prefab unit	-	-	-	-	●	●	1	3	-	2	●
VIP prefab unit	-	1	1	1	1	●	1	4	30L	2	●
2+3 prefab unit	-	4	2	3	3	●	1	4	300L	2	●
5 Toilet prefab unit	3	3	-	5	6	●	1	3	30L	2	●
5 Shower prefab unit	-	6	5	-	1	●	1	6	300L	2	●

● = Optional configuration

# Prefabs delivered as flatpack



# Erected on site by ICS' fast response teams



Site office units for Masdar Developments, Abu Dhabi



Accommodation facilities



Mounting of trusses for pitched roofing



Accommodation units for MASDAR Development, Abu Dhabi

# Office buildings



Office

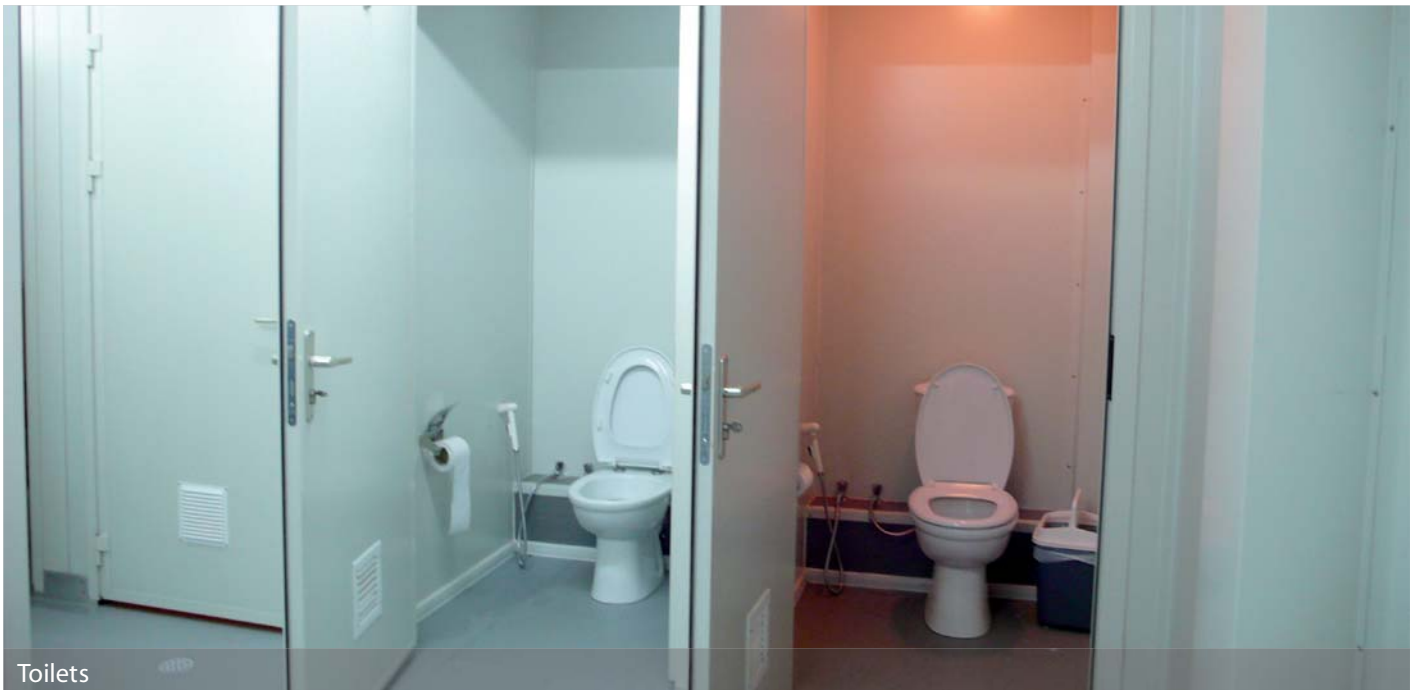

Toilets



Labour camp accommodation and ablution facilities

# Office buildings - Shops - VIP lounges



Office facilities



Combined office and ablution facilities



Prefab unit as shop



Dining hall



Office and administration facilities



Stadium VIP lounge



Fitness

## 2 storey accommodation buildings



Two storey building for accommodation and ablution

## 3 storey accommodation buildings



## Camps



Accommodation unit in Al Ain



Generators and Water Tanks



Camp in Al Ain, UAE for training of Managers

# General description of ICS 20' Prefab Unit

The standard flatpacked unit is extremely suitable for international transport. It has connections for lifting and fixing or compounding. It is designed as a light construction consisting of floor, roof frames and corner profiles.

## Handled by any ISO means

Material shipped inside the flatpack is packed so as to ensure complete immobility during the transport by all kind of roads.

The assembled flatpacked units are solid enough to enable transport and handling by any ISO means.

## Modular and scalable to fit any needs

The flexible and modular construction enables unlimited expansion in either length or width. Furthermore, the construction is stackable. It can go as much as 2 floors in height (ground floor + first floor), or up to 3 floors in height for warehousing of these flatpacked units (ground floor + 2 floors). It is designed to reduce your need for land.

## Insulated to save power energy

The wainscots of the flatpacked unit are made of light mineral wool insulation panels and offer pleasant interior climate due to their building and physical properties.

## Reduces logistic costs up to 4 times

ICS modular structures are stored in a "flatpack" compressed configuration with a 640 sqft. apartment requiring only 8' width by 20' length by 8' high to store it. The construction of the flatpack is solid enough to enable transport and handling of up to 4 units at a time. When transported, one standard flat-bed truck can carry up to 1,280 sqft. of housing space.

## Rapid assembly

ICS modular products are specifically designed for rapid assembly into multi-story buildings for use as site offices, labour camps, apartments, dormitories, offices, public use facilities such as cafeterias, recreation areas and much more.

## Saves footprint and need for land

By utilizing a multi-story apartment approach, more people can be housed within a smaller footprint than with normal solutions and a more attractive community can be created. ICS modular structures are universal in application. The components can be assembled in an unlimited number of configurations to meet any specific need.

## Reusable units

Once no longer needed, ICS modular structures can be easily dismantled and returned to their "flat-pack" configuration, and returned to storage for reuse at another time.

## Long life and low Life Cycle Costs

ICS modular structures are multi re-usable and extremely fast moveable. If they are needed at another site or place nearby, they can simply be picked up by a crane and moved immediately - without damaging the structure. Life expectancy is 10 years.

## Technical data ICS 20' prefab unit components

### Dimensions

Follows the international ISO standard 668.  
External: L 6058 x W2438 x H2591 mm  
Internal: L 5875 x W2255 x H2326 mm

### Steel framework

Material: Cold formed steel profiles on a thickness of 2-4 mm.  
Surface working: Sand blasting and painting total ground coat of min. 110 µm.  
Fittings: Locking holes according to international ISO standard 1161.

### Floor

Composition:  
• external wainscot: galvanised steel sheet metal in a thickness of 0.5 mm  
• Insulation filling: 100 mm mineral wool among transverse supports  
• steam blockade: PE foil  
• Plywood panel.  
• glued final linoleum PVC floor covering in a thickness of 1.5 mm with welded connections.  
Permitted loading: 2.0 KN/m<sup>2</sup>  
Coefficient of thermal conductivity: k = 0.33 W/m<sup>2</sup>K

### Ceiling

Composition:  
• external wainscot: flat galvanised and painted steel sheet metal in a thickness of 0.5 mm.  
• insulation filling: 100 mm mineral wool among wood purlins.  
• steam blockade: PE foil in a thickness of 200 µm  
• inner wainscot: chipboard with foil in white colour.  
• Meteor water outlet: 4 each of PVC rainwater pipes.  
Permitted loading: 1.00 KN/m<sup>2</sup>  
Coefficient of thermal conductivity: k = 0.32 W/m<sup>2</sup>K

### Facade walls

Composition:  
• external wainscot: plain profiled, galvanised and painted steel sheet metal in a thickness of 0.5 mm  
• internal wainscot: plain profiled, galvanised and painted steel sheet metal in a thickness of 0.5 mm  
Permitted loading: 0.50 KN/m<sup>2</sup>  
Coefficient of thermal conductivity: k = 0.6 W/m<sup>2</sup>K

### Doors

External door: One (1) single fold, filled door, light opening approx. 810/2000 mm, furnished with a cylinder lock.

### Window

One (1) window of PVC, single fold, white colour, in dimensions approx 885/1200 mm and opening mechanism - side and top type.

### Electrical Specifications

- Standard: according to BS (British Standard) regulations
- Voltage: 230/400 V, 50 Hz
- Network connection: CEE-connection plug/socket, 5-pole 5x32 A, 400 V, recess in steel frame.
- Connection between prefab units: rubber cable 5x6 mm<sup>2</sup>, 1.5 m long, with CEE plug and socket 5x32 A at each end - optional.
- Inner distribution system: electric distribution box, dopper/PVC/PVC flexible cables of suitable dimensions (6.0 mm<sup>2</sup>, 2.5 mm<sup>2</sup>, 1.5 mm<sup>2</sup>), surface mounted.
- Protection power supply F1-Switch (40/4E-0,03A), automatic fuses
- Earthing: galvanised connector with a cross clip of dimensions 100x25 mm welded on the bottom frame. Optional earthing conductor of flexible copper cable.

### Fittings:

- electric distribution box
- single fluorescent light 1x58 W - 2 each
- switch 230 V - 1 each
- 13A, 230V BS type sockets - 2 each
- 15A, 230V BS type sockets - 1 each
- 12A, battery operated smoke detector - 1 each

### Heating - optional

Electric wall convector with a power of 2.0 kW with a thermostat.

### Colour, sign writing

Steel construction painted in RAL 9002 colour.  
Wall colour: outer RAL 9002, inner RAL 9002 or RAL 7035. Doors and windows in white colour.

### Tools and instruction for assembly

Inside each package are provided:

- 310 ml silicon putty, two packs (white and clear colour) in each.
- Detailed information manual in English for assembling and disassembling of the prefab unit with all necessary drawings and list of items with numbering. Tools not provided.

### Possibilities of prefab unit mounting

- on point foundations (concrete cubes, dimensions 25/25/25 cm, 6 each)
- on band foundations (concrete band, 25 cm wide, on the prefab unit circumference. These depends on the ground condition)

### Partition Walls

Same specification as facade walls.

### Cubicles

Made of high pressure solid grade compact laminate of 13mm thickness suitable for wet areas. Complete cubicle consisting of front posts, divider panel and door.

Hardware : Stainless steel with aluminium top rail.

### Water, toilet and shower Installations

Distribution of sanitary water: poly-propylene pipes 1/2" and 3/4" (type 3 according to DIN 8078), surface-mounted.

Waste pipe: PVC pipes, diameters 50 mm and 110 mm, surface-mounted

Prefab unit connections: on facade wall ; PVC pipe, diameter 110 mm, galvanised pipe 3/4"

Fittings:

- Ceramic toilet pan with a PVC toilet lid, a cistern, low mounted reservoir of 7.5 l capacity and toilet paper holder. Optional stainless steel.
- Acrylic shower base, dimensions 800/800 mm with a shower cubicle, PVC curtain and mixing shower head. Optional stainless steel.
- Ceramic washbasins, dimensions 395/340 mm with an outlet siphon, mirrors 600/400 mm with shelf, towel hooks and mixing taps - 4 each  
Optional stainless steel

Ventilation: Standard ventilation grills and electric extractor fan 100 mm of capacity 75 m<sup>3</sup>/h - 1 each

SPECIFICATIONS ARE SUBJECT TO CHANGES WITHOUT NOTICE AND CAN VARY BETWEEN DIFFERENT TYPES OF ICS PREFAB UNITS

# ICS Group's offices and branches

---



## **A truly global outlook**

The ICS Group operates in many different countries and regions, and projects are managed by staff from our headquarters or on regional offices, often collaborating on the projects.

Our employees are a mixture of local people and skilled teams from our subsidiaries.

Our role may involve being either a prime contractor, a team member in a consortium or a subcontractor.

Furthermore, in many countries ICS Group also works with local partners.

*Contact us today for further information.*

## ● **ICS Group A/S**

Sales Office, Main Office  
and Warehouse

Virkelyst 8

DK-9400 Nr.Sundby

- Denmark

T +45 7023 1380

F +45 7023 1381

sales@ics-group.net

www.ics-group.net

## ● **ICS Group LLC, Dubai**

Head Quarter, Middle East

T +971 43977042

F +971 43977043

dubai@ics-group.net

www.ics-group.net

## ● **ICS Group LLC, Abu Dhabi**

Sales Office

T +971 43977042

F +971 43977043

abudhabi@ics-group.net

www.ics-group.net